

## GLOSSARY OF BUILDING TERMS

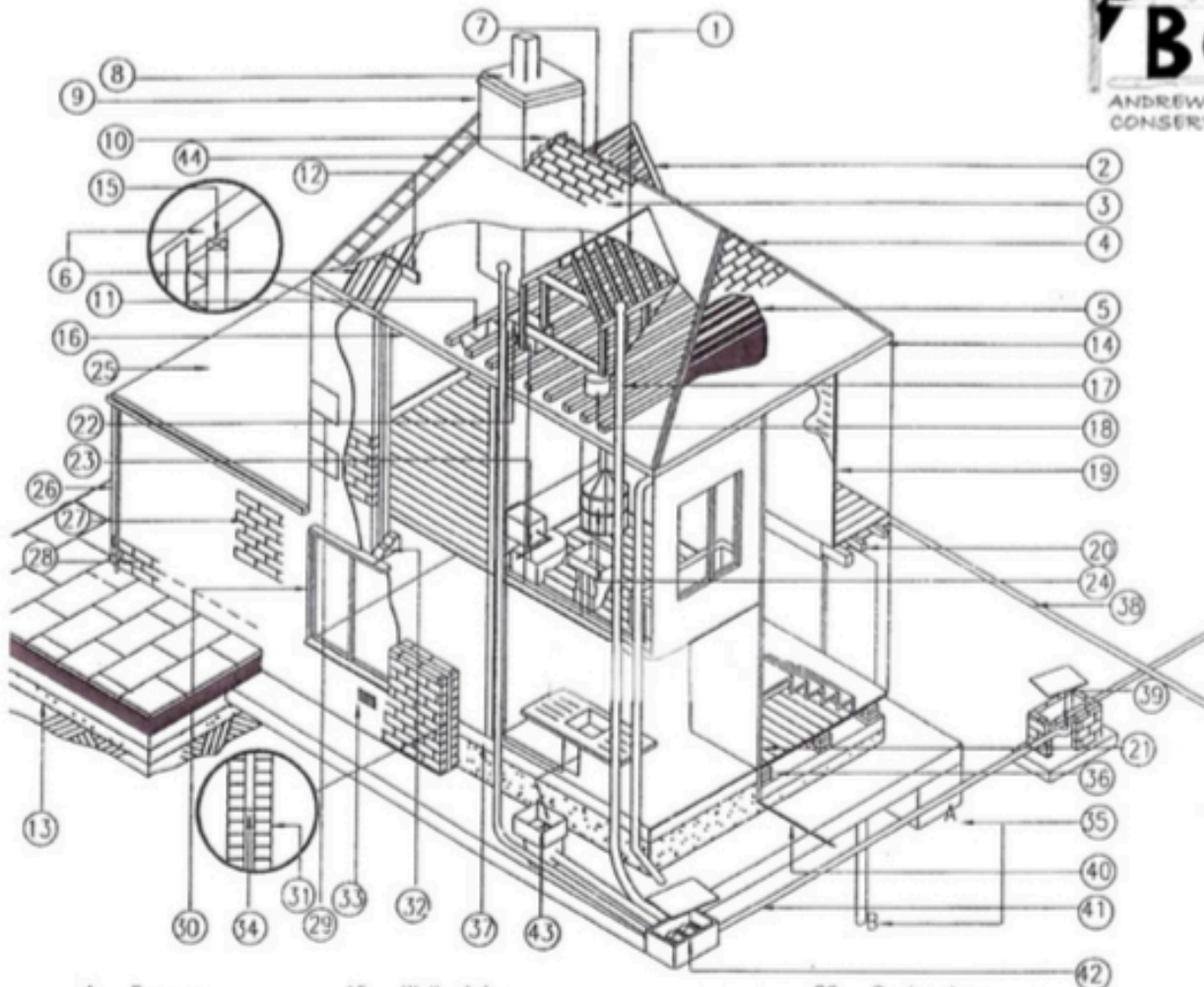

- |                      |  |                                  |
|----------------------|--|----------------------------------|
| 1. Dormer            | 15. Wall plate                           | 29. Quoin stone                  |
| 2. Barge board       | 16. Soffit to underside of eaves         | 30. Reveal                       |
| 3. Slating or tiling | 17. Soil and vent pipe                   | 31. Cavity brick or block wall   |
| 4. Hip               | 18. Central heating header tank          | 32. Concrete or steel lintel     |
| 5. Felt and Battens  | 19. Timber stud wall                     | 33. Air brick                    |
| 6. Rafters           | 20. Floor joists                         | 34. Wall lies                    |
| 7. Ridge             | 21. Solid wall                           | 35. Underpinning (A&B)           |
| 8. Flaunching        | 22. Cold water storage tank              | 36. Wall plates on sleeper walls |
| 9. Chimney stack     | 23. Overflow pipe                        | 37. Concrete slab                |
| 10. Flashing         | 24. Hot water cylinder                   | 38. Water main                   |
| 11. Insulation       | 25. Felt with stone chippings on decking | 39. Interceptor trap             |
| 12. Purlin           | 26. Gutter and rainwater pipe            | 40. Electricity main             |
| 13. Hardcore         | 27. Fair faced brickwork                 | 41. Foul drain                   |
| 14. Facia of eaves   | 28. Damp proof course                    | 42. Manhole                      |
|                      |  | 43. Gully with grating           |
|                      |  | 44. Water Tabling                |

**Andrew's Building Conservation**  
**T: 08451161381 M: 07703811381**  
[www.andrewsbuildingconservation.co.uk](http://www.andrewsbuildingconservation.co.uk)